



**KING COUNTY**

1200 King County Courthouse  
516 Third Avenue  
Seattle, WA 98104

**Signature Report**

**August 21, 2001**

**Ordinance 14186**

**Proposed No. 2001-0390.2**

**Sponsors Fimia**

1 AN ORDINANCE relating to traffic control, prohibiting  
2 stopping, standing, or parking during certain hours on  
3 certain streets as authorized under K.C.C. 46.04.060A.3;  
4 and amending Ordinance 5292, Schedule 16.

5

6

7

BE IT ORDAINED BY THE COUNCIL OF KING COUNTY:

8

SECTION 1. Based on traffic engineering studies carried out by the department

9

of transportation, road services division and as authorized under K.C.C. 46.04.060A.3,

10

Schedule 16 of Ordinance 5292, which prohibits stopping, standing, or parking during

11

certain hours on certain streets, is amended to add the following roadway:

12

NE 178th Street, on the north and south sides, between 90th Avenue NE and 92nd

13

Avenue NE from 7:30 to 2:00 p.m.—school days only.

14            SECTION 2. Signs posted to evidence the above-described restriction shall be  
15 installed by the proper authority.

16

Ordinance 14186 was introduced on 7/23/01 and passed by the Metropolitan King  
County Council on 8/20/01, by the following vote:

Yes: 12 - Mr. von Reichbauer, Ms. Miller, Mr. Phillips, Mr. Pelz, Mr.  
McKenna, Ms. Sullivan, Mr. Nickels, Mr. Pullen, Mr. Gossett, Ms. Hague,  
Mr. Thomas and Mr. Irons  
No: 0  
Excused: 1 - Ms. Fimia

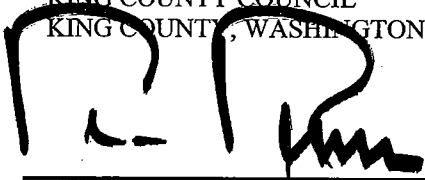
KING COUNTY COUNCIL  
KING COUNTY, WASHINGTON  
  
\_\_\_\_\_  
Pete von Reichbauer, Chair

ATTEST:

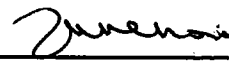
  
\_\_\_\_\_  
Anne Noris, Clerk of the Council

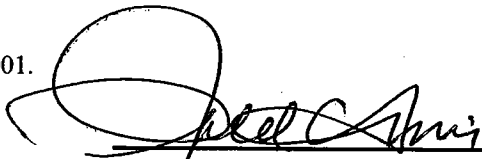
APPROVED this 24 day of August, 2001.   
\_\_\_\_\_  
Ron Sims, County Executive

**Attachments**      A. Affected Area Maps, B. Petition for Corrective Measures



# Affected Area Map

2001 390

Attachment A

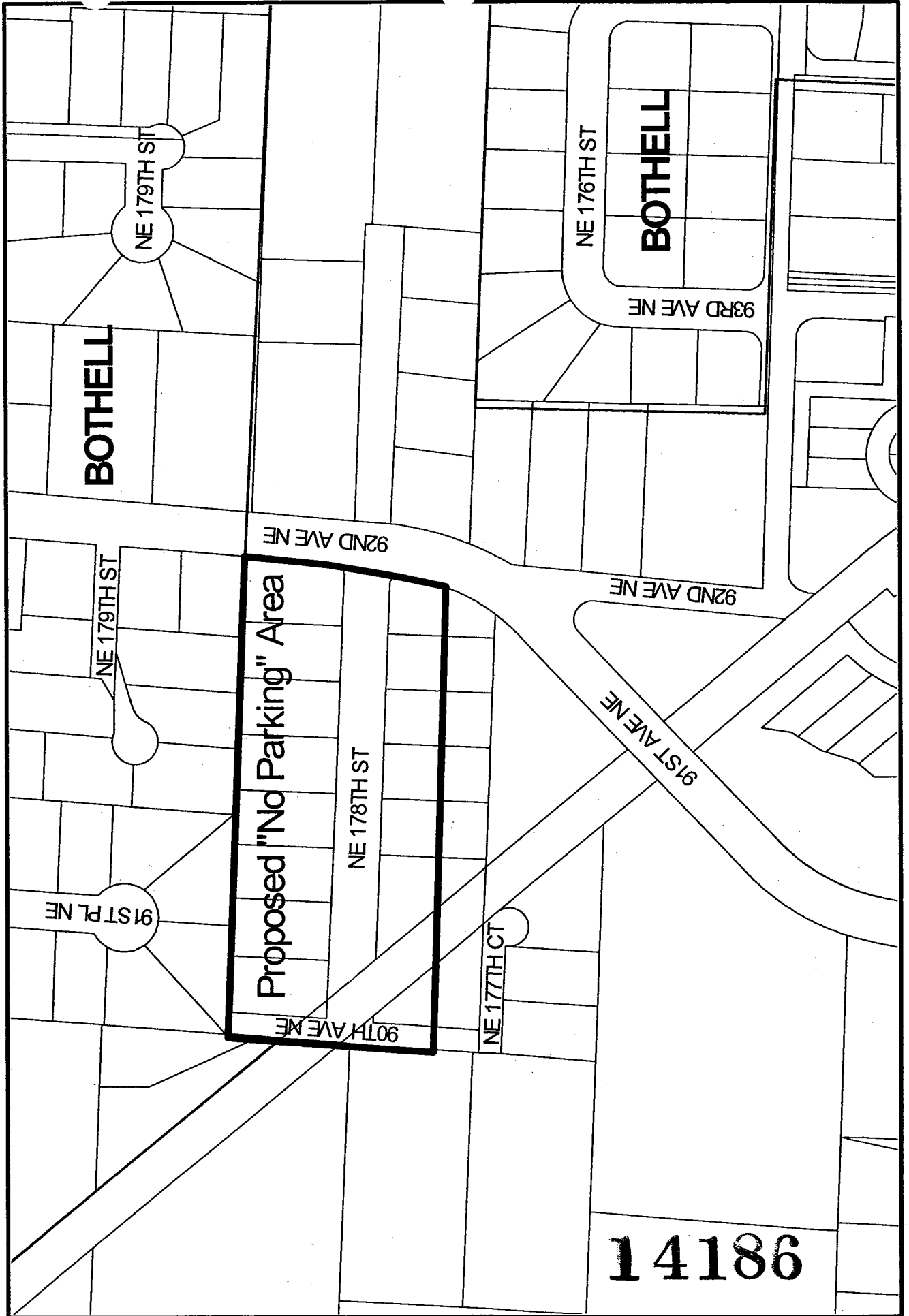



14186

PETITION FOR CORRECTIVE MEASURES

2001 390

King County Department of Transportation
King Street Center M.S/ KSC-TR-0222
201 S Jackson Street
Seattle, WA 98104-3856

Attention: Michael V. Magher, School Safety Engineer, Traffic Engineering Section

From: Residents of NE 178th Street, Bothell, WA 98011

RE: Traffic Control and Parking Restrictions

The residents of NE 178th Street, Bothell, WA hereby submit an urgent request for corrective measures to be implemented immediately in an attempt to resolve ongoing and potentially hazardous circumstances resulting from the irreverent misuse of our street by the students of Bothell High School. Excessive speed and reckless behavior by the students is a daily occurrence (Monday through Friday) which places the lives and safety of our children at great risk. We jointly and respectfully request that King County post restrictive parking signs, (i.e., NO PARKING between 7:00 am and 2:30 pm) on both sides of the street to eliminate this serious situation.

Address 9043 N.E. 178th St Esther R. Machon
Willard Machon

Address 9043 N.E. 178th St

Address 9049 N.E. 178th St Helen C. Piispanen

Address 9057 N.E. 178th St. AXEL + LYNNEA MAHLKE

Address 9058 NE 178th Jean M. Baldwin

Address 9058 NE 178th James Awabak

Address 9050 NE 178th Jean Schner

Address 9040 NE 178th St Kelly R. Stober

Address 9034 NE 178th St. Jeffery R. Stober

Address 9021 N.E. 178th St. Jean + Jeffery Dicks

Address 9026 NE 178th St. James M. Pittman

Address 9033 NE 178th St. James C. Wiggle

Address 9012 N.E. 178th St. Bruce J. Wade

Address 9004 NE 178th St. Krista A. White

Address 9007 NE 178th St. David Mumbros

Address 9018 NE 178th St. Daryl L. Knutson

Address 9018 NE 178th St. Jessica Thomas

Address 9018 NE 178th St. David A. ...